



selection Kaminöfen



NEU · NEW · NOVITÀ · NOUVEAU

Starker urbaner Auftritt – Die Neuen in der Kaminofen-Serie selection

In der Kaminofen-Serie selection gibt es drei neue Kaminofen-Modelle: Moro, Sino City und Noto.



Moro



Sino City

A strong urban appearance - The new stoves within the stove-collection selection.
There are 3 new models within the stove-collection selection range: Moro, Sino City and Noto.

Forte immagine cittadina, le nuove stufe a legna della serie selection.
Nella serie di stufe a legna selection ci sono 3 nuovi modelli: Moro, Sino City e Noto

Grande entrée en scène urbaine - Les nouveaux dans la gamme de poêles selection.
Trois nouveaux modèles sont présents dans la gamme de poêles selection: Moro, Sino City et Noto.

Moro

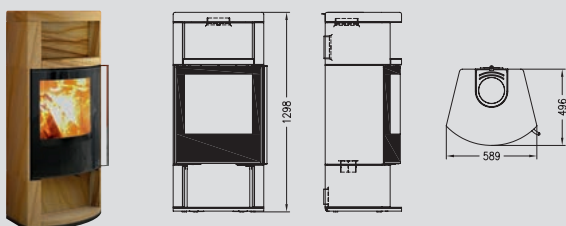

Sino City

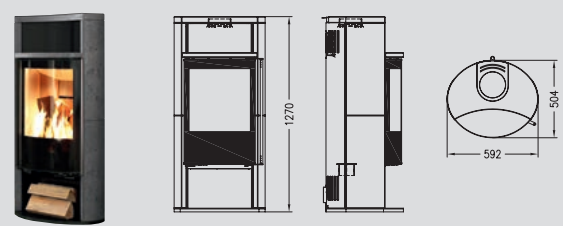

Die Abbildung zeigt den Moro mit optionaler Verkleidung des Holzlegefachs.
The displayed Moro has an optional cover in sand stone of the log storage area.
L'image montre le Moro et son option: le bûcher habillé.
La Foto mostra il nostro modello Moro con vano portalegna rivestito, questa e' una scelta opzionale.

Technische Daten | Technical data | Specifiche tecniche | Données techniques

	Moro	Sino City	Noto
Nennwärmeleistung Nominal heat output Potenza calorifica nominale Puissance nominale	5 kW	5 kW	7 kW
Wirkungsgrad Efficiency Rendimento Rendement	> 80 %	> 80 %	> 80 %
Heizleistung min. / max. Heat output min/max Potenza calorifica min. / max. Puissance de chauffe min./max.	3,5 - 6,5 kW	3,5 - 6,5 kW	4,9 - 9,1 kW
Raumheizvermögen günstig ca. Room heating less favourable approx. Capacità di riscaldamento degli ambienti in condizioni favorevoli circa Capacité de chauffage valable pour env.	165 m ³	165 m ³	186 m ³
weniger günstig ca. less convenient for approx. Capacità di riscaldamento degli ambienti in condizioni meno favorevoli circa moins intéressant pour env.	95 m ³	95 m ³	120 m ³
ungünstig ca. unfavourable approx. Capacità di riscaldamento degli ambienti in condizioni sfavorevoli circa déconseillé pour env.	65 m ³	65 m ³	82 m ³
Holzaufgabemenge Fuel consumption/load Quantità legna/ora Quantité de bois	1,5 kg/h	1,5 kg/h	2,1 kg/h



Noto

Noto

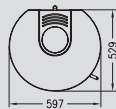
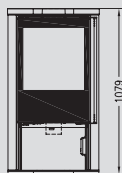

Ausführungen Verkleidung
Designs
Rivestimento
Finition

Ausführung Tür
Door finish
Sportello
Finition de la porte

Naturstein | Natural stone
Vernice | Pierre naturelle

Glas | Glass
Vetro | Verre

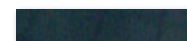

Speckstein
Soapstone
Steatite
Pierre ollaire

Sandstein Caramello
Sandstone Caramello
Pietra arenaria caramello
Grès Caramello

Schwarz bedruckt
Black, printed
Serigrafia di colore nero
Imprimé noir

selection



Technische Daten | Technical data | Specifiche tecniche | Données techniques

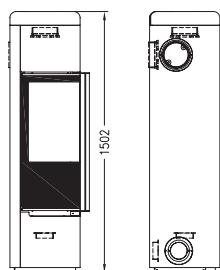

Redoro S

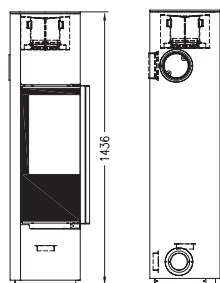
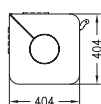

Redoro M

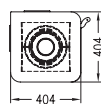

Redoro S Redoro M

Nennwärmeleistung Nominal heat output Potenza calorifica nominale Puissance nominale	5,9 kW	5,9 kW
Wirkungsgrad Efficiency Rendimento Rendement	> 80%	> 80%
Heizleistung min. / max. Heat output min./max Potenza calorifica min. / max. Puissance de chauffe min./max.	4,5 - 7,8 kW	4,5 - 7,8 kW
Raumheizvermögen günstig ca. Room heating less favourable approx. Capacità di riscaldamento degli ambienti in condizioni favorevoli circa Capacité de chauffage valable pour env.	165 m ³	165 m ³
weniger günstig ca. less convenient for approx. Capacità di riscaldamento degli ambienti in condizioni meno favorevoli circa moins intéressant pour env.	95 m ³	95 m ³
ungünstig ca. unfavourable approx. Capacità di riscaldamento degli ambienti in condizioni sfavorevoli circa déconseillé pour env.	65 m ³	65 m ³
Aufgabemenge Fuel consumption/load Quantità legna/ora Quantité de bois	1,7 kg/h	1,7 kg/h



Spartherm Feuerungstechnik GmbH

Maschweg 38 • D-49324 Melle • Germany • info@spartherm.com • www.spartherm.com